

4

3

2

1

241-00-005
Fastener, Custom: Nut, Bottom, R_RL_RLC

241-01-002
Fastener, Custom: Crush Washer, Plastic, R_RL_RLC

TORQUE:
50±5 IN.LB.
(INTO FORK CHASSIS)

IMPORTANT:
INSPECT 100% THAT RETAINING RING
IS FULLY INSTALLED INTO GROOVE FULL 360°

038-00-144
RETAINING RING

029-03-008
O-Ring (-008) [.070 C.S. X .176 ID]

GREASE:
THIN LAYER
OF SLICK HONEY

820-05-223-KIT
TOPCAP ASSY

820-02-384-KIT
AIR SHAFT ASSY

GREASE [2]

TORQUE:
220±5 IN.LB.
(INTO FORK CHASSIS)

[2] APPLY GREASE AROUND PISTON, TRANSFER SHAFT, ON 10MM SHAFT
BETWEEN BUMPER AND NEG PLATE, AND A THIN LAYER ON ENTIRE
LENGTH OF PISTON BORE OF UPPER TUBE ID.

234-04-811
VOLUME SPACER

234-04-881
AIR CAP

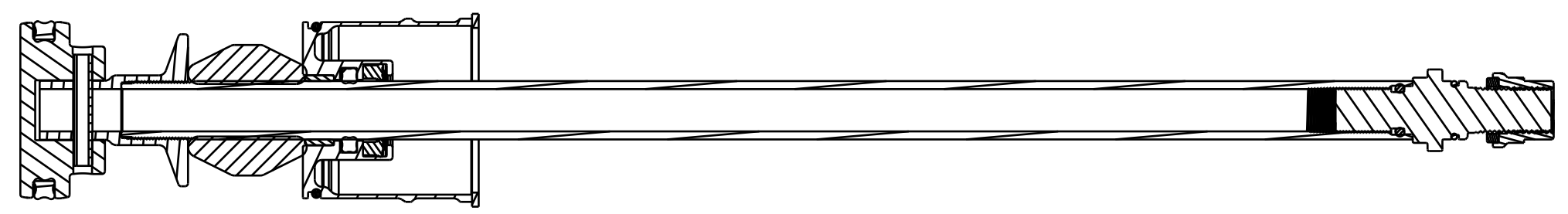
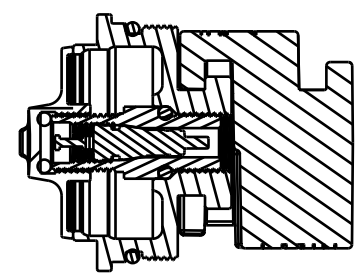

SECTION A-A

FOX		FOX Factory, Inc.	Ph 831-768-1100
		130 Hangar Way, Watsonville, CA 95076 USA	Fax 831-768-9312
TITLE			
Air Spring, FLOAT NA 2			
SIZE DWG. NO.			
C			
PLOT SCALE .00:1		SHEET OF	

- PROPRIETARY -
THIS DOCUMENT CONTAINS CONFIDENTIAL, PROPRIETARY INFORMATION
THAT IS FOX PROPERTY. DO NOT DISCLOSE TO OR DUPLICATE
FOR OTHERS EXCEPT AS AUTHORIZED BY FOX.

4

3

2

ProE ASSEM